

## Power Sensor Components

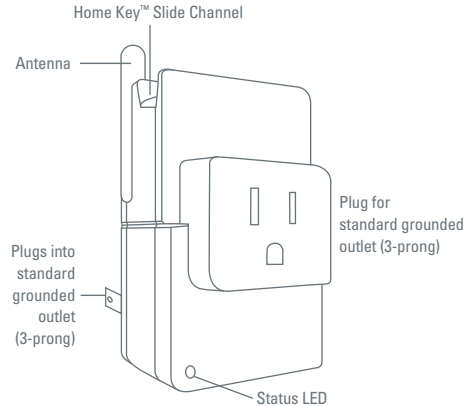

## Power Sensor Uses:

- Home Computer
- Curling Iron
- Toaster Oven
- Gaming System
- Stereo
- Sump Pump
- Coffee Maker
- VCR
- Microwave
- Power Tools
- Outdoor Lighting
- Appliances

### FCC Statement

(Compliance Statement, Part 15.19): This device complies with Part 15 of the FCC Rules. Operation is subject to the following two conditions: (1) this device may not cause harmful interference, and (2) this device must accept any interference received, including interference that may cause undesired operation.

WARNING (Part 15.21): Changes or modifications not expressly approved by the party responsible for compliance could void the user's authority to operate this equipment.

To comply with FCC's RF exposure limits for general population/uncontrolled exposure, the antenna(s) used for this transmitter must be installed to provide a separation distance of at least 20 cm from all persons and must not be co-located or operating in conjunction with any other antenna or transmitter.

### Industry Canada Statement

The term "IC" before the certification/registration number only signifies that the Industry Canada technical specifications were met.

### Interference

This equipment has been tested and found to comply with the limits for a Class B digital device, pursuant to Part 15 of the FCC rules. These limits are designed to provide reasonable protection against harmful interference in a residential installation. This equipment generates, uses, and can radiate radio frequency energy and, if not installed and used in accordance with the instructions, may cause harmful interference to radio communications. However, there is no guarantee that interference will not occur in a particular installation. If this equipment does cause harmful interference to radio or television reception, which can be determined by turning the equipment off and on, then the user is encouraged to try to correct the interference by one or more of the following measures:

- Reorient or relocate the receiving antenna
- Increase the separation between the equipment and the receiver
- Connect the equipment into a power source on different circuit than the receiver.

### Sensor Maintenance

No serviceable parts. Clean with a soft, dry cloth.

HOMEheartbeat™  
- Lightbulb icon - Power Sensor

## Power Sensor

### 1 Plug in

**CARRY** the sensor and the Home Key to the location where you want to place it. Plug the Power Sensor into the wall outlet.

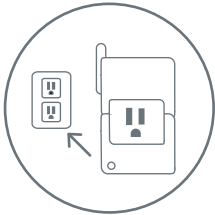

### 2 Set up

**CLICK** the Home Key thumbwheel to wake the screen, then **SLIDE** the Home Key into the channel on the top of the sensor. The Home Key screen should say:

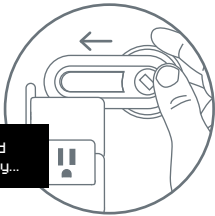

Device found  
OK to remove Key...

Please wait...  
Device found  
OK to remove Key.

Follow the instructions on the Home Key screen to join the Power Sensor to your system, name it, choose sensitivity options, and set **In-Home Awareness** and **"CallMe" Awareness**. The sensitivity options allow you to adjust the system to correctly identify when appliances are on or off, because individual appliances draw different amounts of power. After options are set and you click **Done, go back?**, the Home Key screen will indicate that the sensor is joined to system. You may go to Step 3.

If you slide the Home Key into the sensor Slide Channel and the Home Key screen shows either of the following messages, it means that the Home Key or sensor may be outside the range of the Base Station.

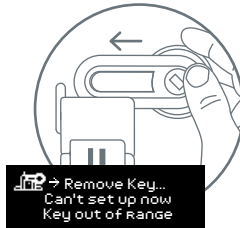
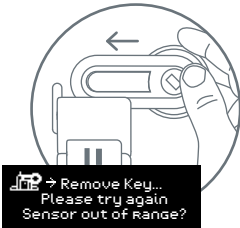

If the Home Key or sensor is out of range, you can:

- Add a Home Heartbeat Range Extender between the Base Station and Power Sensor, or
- select an alternate location for the Power Sensor, or
- try moving the Base Station to a more central location in your home. Then, complete Step 1 again.

### 3 Test and use

**PLUG** an electrical device\* into the sensor. The Status LED will blink when the device is drawing power.

*\*For use with electrical devices running at a 15 amp, 120 VAC maximum.*

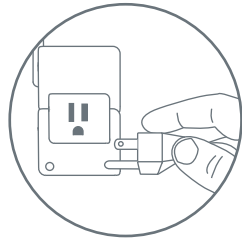

Turn the device plugged into the sensor on and off, checking the Home Key screen for feedback.

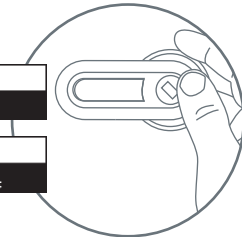

Note: If you find that the Home Key does not show your appliance shifting between on and off, you will need to change the sensitivity setting. If the Home Key shows your device (such as a VCR) as "on" even when you turn it off, try choosing a less sensitive setting. If it shows the device as "off" when it is on, try a more sensitive setting. Appliances that cycle on and off during normal operation, such as coffee pots, air conditioners, or clothing irons, will accurately reflect that state on the Home Key.



Need help? Call **1-800-813-2199** for customer support or visit [www.homeheartbeat.com](http://www.homeheartbeat.com)

#### If Your Power Sensor . . .

- will not respond, make sure the outlet it is plugged into actually has power.
- does not send a signal to the Base Station, move the sensor and Base Station closer together (or consider getting a Home Heartbeat Range Extender).

**EATON**